

HD Photo Trap with 4G connectivity

Dear customer, thank you for purchasing our product. Please read the following instructions carefully and follow them to serve you safely and to your full satisfaction. This will prevent misuse or damage. Avoid unprofessional handling of this equipment and always observe the electrical appliance usage guidelines. Keep the instruction manual carefully. For more information on the photo trap and its application, please refer to www.youtube.com under the title "**Solight FP05GSM - Application Instructions**".

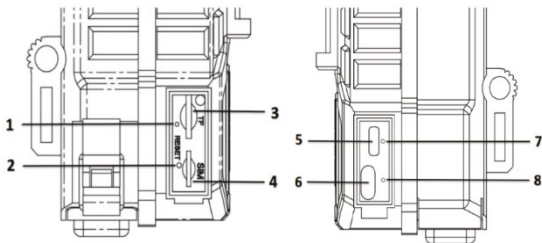

- | | | |
|--------------------------------|------------------------------|---------------------------|
| 1. Memory card indicator light | 2. Reset button | 3. TF Memory Card |
| 4. SIM card (nano) | 5. USB-C interface | 6. Switch Off/Photo/Video |
| 7. Charging indicator light | 8. Operation indicator light | |

BASIC INFORMATION

- High-resolution photos and video
- Night vision in HD quality
- Wide-angle lens
- Photos and videos show date and time information
- TF card support
- Cloud storage option (paid)
- Remote management of the photo trap and viewing of saved files, online transfer option

TECHNICAL PARAMETERS

Photo resolution	5120X2880
Photo format	JPG
Video resolution	2560X1440
Video format	MP4
Language in the menu	English, Chinese
Memory card	Max 128GB
USB	TYPE-C-USB 2.0
Batteries	3x18650 battery/3.7V
Working temperature	-30°C to 50°C
Dimensions	80x70x139mm
Coverage	IP65

FIRST CONSECRATION

Battery insertion:

Open the battery compartment at the bottom left of the device (as shown in the picture), insert 3 pieces of 18650 batteries.

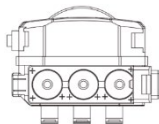

SIM and TF card insertion:

Open the compartment on the bottom left side of the device and insert the cards. The device supports nano-sized SIM cards. The SIM card must have a cancelled PIN.

Remark:

Only handle the SIM and TF card when the device is switched off!

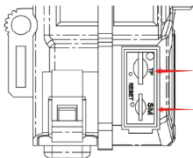

Controls:

Charging light: the light is green when charging and goes off when fully charged.

SIM light: The LED is red when the photo trap is not connected to the network. If the photo trap is searching for a signal, the LED flashes blue, when a signal is found the LED turns blue.

Use switch No.6 on the side of the device to

1. device switched off
2. switch on / photo mode
3. switch on / video mode

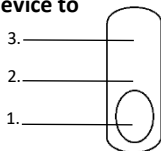

MOBILE APP DOWNLOAD

To download the mobile app, scan the QR code or search for it under UCON on the App Store (for Apple devices) or Google play (for Android devices).



Registration and login

Launch the mobile app and log in by clicking "Login". If you do not have an account, please continue with the following steps.

1. Select your country and fill in your email address. After reading the terms of use of the application, check the box "I read and agree to User Agreement and Privacy Policy" and click on the button " Register " (shown in Figure 1).
2. Fill in the password in the line " Enter password ", confirm the password in the line " Confirm password ", Overwrite the code from the image in the line " Input Code " (shown in Figure 2).
3. After successful registration in the mobile app, confirm the confirmation email. And log in by clicking on the button " Login " (shown in Figure 3)

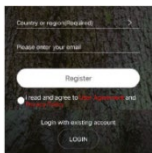

Fig. 1

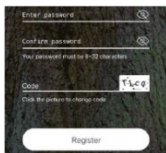

Fig.2

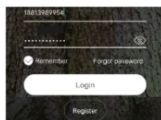

Fig.3

4. To add a device, click on " Add a device " (Fig. 4.) and select " Setup 4G Device " (Fig. 5.).
Insert the SIM card, connect the antenna and switch on the device. After approximately one minute, the blue light above the SIM card input will light up and click "Next"
in the mobile app (fig. 6).
5. Scan the QR code on the back of the photo trap (Fig. 7).
6. Click in the "Device" field and then "Customize" to enter the device name.

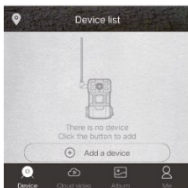

Fig. 4



Fig. 5



Fig. 6

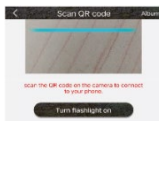
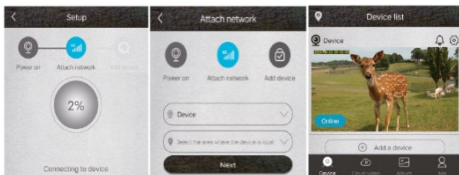
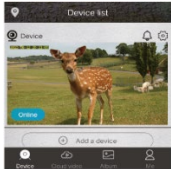
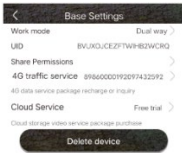

Fig. 7



Settings in the mobile app

On the " Device " tab, click on your device and then on the cogwheel in the upper right corner, here you can set additional parameters. For more information on the photo trap and the application, please visit www.youtube.com under the title **"Solight FP05GSM - Application Instructions"**.



Safety notice

1. This device is powered by a lithium battery. On a full charge, the device is expected to be switched on up to 2000 times (approx. 10 times a day) and last approximately 3 months on a full charge. Frequent switching will shorten the usage time. If the battery voltage is low, the mobile app will display an alert, charge the device in a timely manner after receiving the alert.
2. During installation, make sure there is sufficient signal at the installation site. If the signal is weak, the installation site needs to be adjusted.
3. It is a low power consumption device. The device can be triggered remotely by a mobile app or automatically by a PIR sensor. Each time the device is activated, it automatically goes to sleep after a certain period of time.

Statement

1. If you do not use the photo trap for a long period of time, remove the battery to prevent damage to the camera due to a possible battery failure.
2. The manufacturer accepts no liability if the product is used for purposes other than those for which it was manufactured.
3. It is forbidden to disassemble the device.

Tips

Memory card

- This device can use a Class 10 or higher high-speed TF card. Format the memory card before using it for the first time.
-

About the product

- This photo trap is equipped with efficient infrared LEDs in the invisible 940 nm band, a lens and a PIR sensor
- If the lens or PIR sensor is dirty during use, clean it.
- Cleaning steps: try blowing or gently picking out the dirt. Do not try to wipe the lens or sensor with a high pressure cloth, otherwise further scratching may occur. Scratches on the lens or PIR sensor reduce the quality of detection and image recording.
- Before using this camera, remove the protective film on the PIR sensor and the protective film on the lens.
- Do not place the camera near heat sources or free-flowing chemicals. Do not install on equipment that may emit mechanical vibrations.

CZ Návod v českém jazyce je dostupný na www.solight.cz

SK Návod v slovenskom jazyku je dostupný na www.solight.sk

This symbol on the product or in the accompanying documentation indicates that the product must not be disposed of with mixed household waste. This product is intended for environmentally friendly disposal, so take it to the designated collection point. For further information on the environmentally sound disposal of the product, please contact your local authority, your household waste collection and disposal provider or your dealer. By disposing of your product in an environmentally friendly manner, you are helping to protect the environment.

This product complies with all the essential requirements of the EU Directives that apply to it.

The product has been issued with a CE declaration of conformity in accordance with the applicable regulations. On request from the manufacturer: info@solight.cz, or download www.solight.cz/en



SOLIGHT

Solight Holding, s.r.o., Na Brně 1972, Hradec Králové 500 06, Czech Republic.